

# Vaginal Sample Collection Instructions

For the Vaginosis and Group B Strep Tests

**Please note: Samples should be shipped the day they are collected. If absolutely necessary vaginal samples can be kept at room temperature and shipped the next day.**

## Step 1: Specimen Collection

1. Write your name and date of birth on the tube.
2. Insert the collection swab two inches into vaginal opening, rotating for 15-30 seconds, rubbing the swab against the walls of the vagina.
3. Insert the swab into the tube.
4. Break the shaft of the swab at the score mark and tightly recap the tube.

## Step 2: Preparing Specimen Shipments

1. Place the sample tubes containing the vaginal sample and the included absorbent material into the biohazard bag.
2. Include the requisition if you have one, complete with your information, inside the biohazard bag or the bag's outer pocket.
3. Seal the bag by removing the sealing film.
4. Mailing with FedEx: Place the sealed biohazard bag(s) in the ambient pack and place back into the NxGen MDx collection kit. Place the collection kit into the included prepaid FedEx Clinical Mailer bag and seal it. Place the bag in a FedEx dropbox or location. Visit [www.fedex.com/en-us/home](http://www.fedex.com/en-us/home) to search for your nearest FedEx location or dropbox.

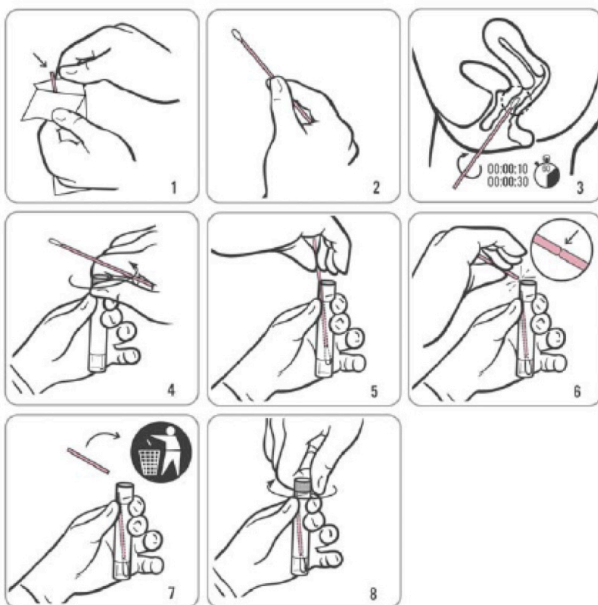

*(Illustrations courtesy of Gen-Probe Incorporated, San Diego CA)*



eSwab

### IMPORTANT

- Labeling is required by the Department of Transportation for all human samples.
- The inclusion of absorbent material in the shipping bag is required by the Department of Transportation for all specimens.